



AGS-1000-RD FIBREGLASS SEWAGE STORAGE TANK

Overall Weight: Approx. 186 kg (410 lbs)

Capacity: Approx. 4,540 L (1,000 Imp Gal, 1,200 US Gal)



Note:

- Various inlet & outlet fittings available including bulkhead fittings, couplings, pipe, flanged fittings, vents, etc. at extra cost.

- Tank comes unassembled (Tank can be assembled at factory at extra cost)

4" PVC-DWV
Coupling

TOP VIEW

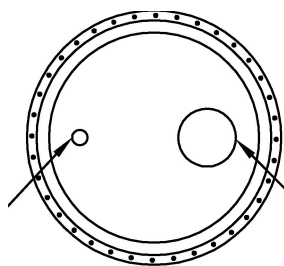

15" Dia. Poly Lid

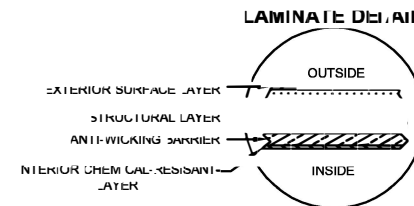

FLANGE CONNECTION DETAIL

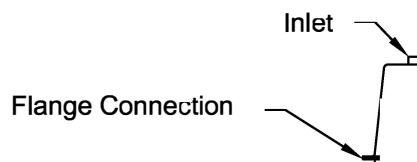
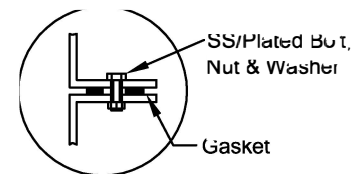

Manway

24"
[610mm]

24"
[610mm]

24"
[610mm]

24"
[610mm]

8'
[2438mm]

5'-6"
[1676mm]