

**SECTION-JOINT
DETAIL**

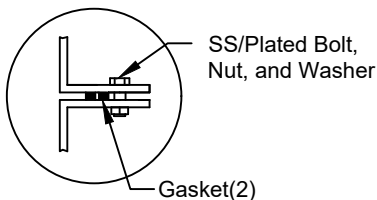

FLANGE CONNECTION DETAIL



Specifications

Total Cylinder Thickness	0.375"	Liquid Depth (holding tank)	88"
Total End Cap Thickness	0.475"	Septic Chamber Depth	N/A
Inlet Height (C.L.)	90"	Effluent Chamber Depth	N/A
Outlet Height (C.L.)	N/A	Chamber Wall dimensions	
Inlet Diameter	4"	Height:	N/A
Outlet Diameter	N/A	Thickness:	N/A
Rib Dimension (C to C)	17.25"	Opening Diameter:	N/A
Rib Overlay Thickness	0.250"	Layers of Woven (Rib)	1

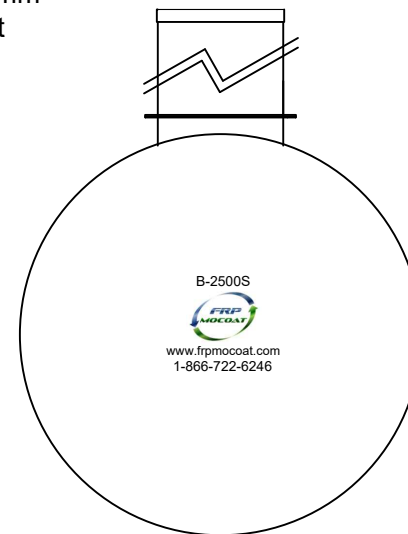
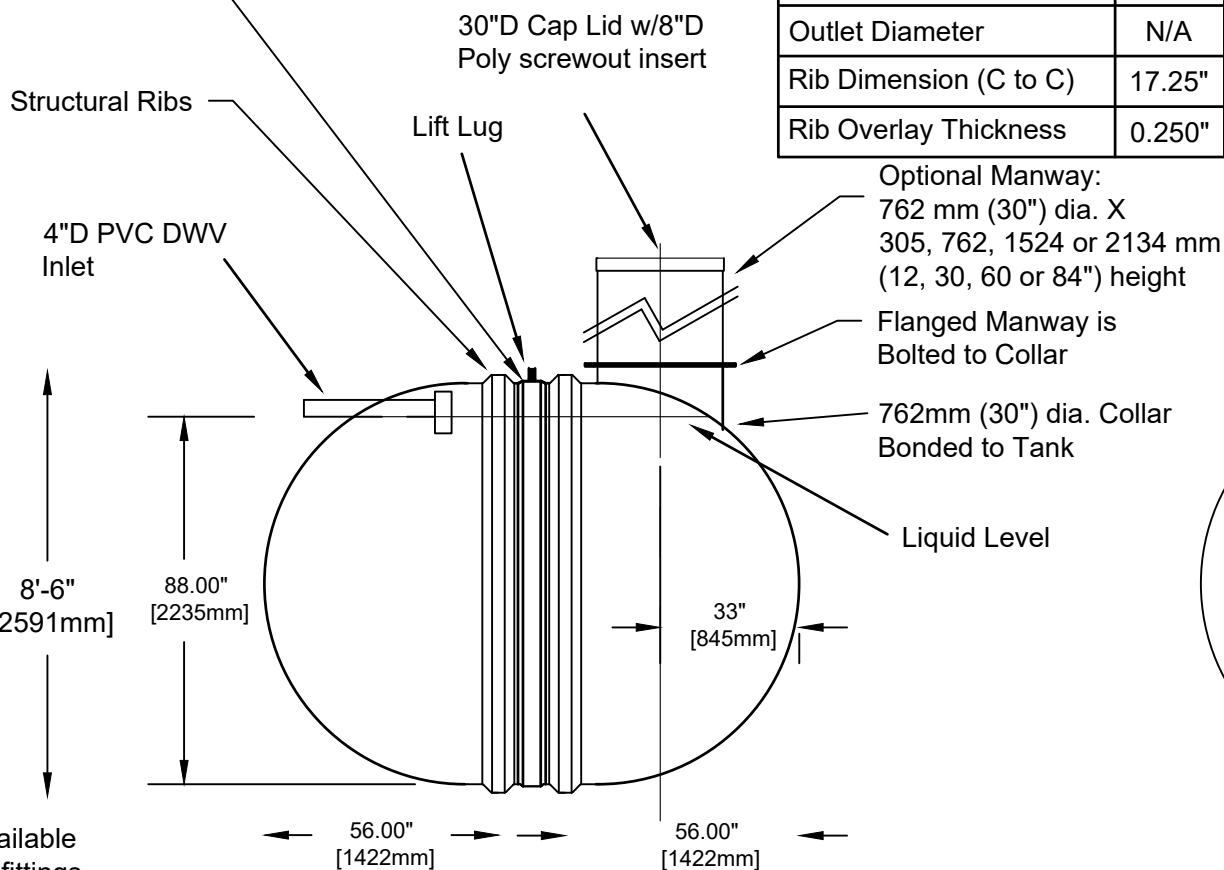

Various fittings available including bulkhead fittings, pipe, flanged fittings, vents, etc. at extra cost.



Website: www.frpmocoat.com
Toll Free: 1-866-722-6246

B2500S FIBREGLASS SEWAGE HOLDING TANK		DATE: 04-22-2022	REV: 4
Overall Length:	Approx. 3,251mm (10'8")	BY: MPS	
Overall Weight:	Approx. 544 kg (1,200 lbs)	BURIAL DEPTH: 7 Ft	
Working Capacity:	Approx. 11,080L (2,437 Imp Gal, 2,924 US Gal)	DATE:	
Overall Capacity:	Approx. 11,365L (2,500 Imp Gal, 3,000 US Gal)	APPROVAL:	

