

# Specifications

Cylinder Thickness	0.375"
End Cap Thickness	0.475"
Inlet Height (C.L.)	N/A
Outlet Height (C.L.)	48"
Inlet Diameter	N/A
Outlet Diameter	2"
Rib Dimension (C to C)	17.25"

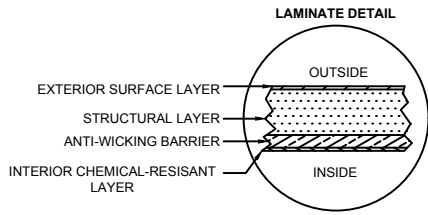

## FLANGE CONNECTION DETAIL

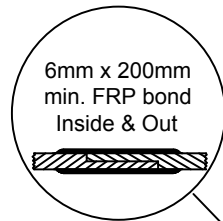
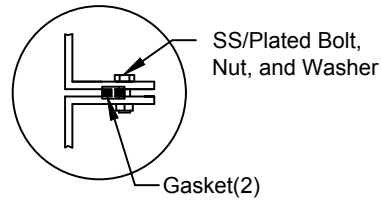

## SECTION-JOINT DETAIL

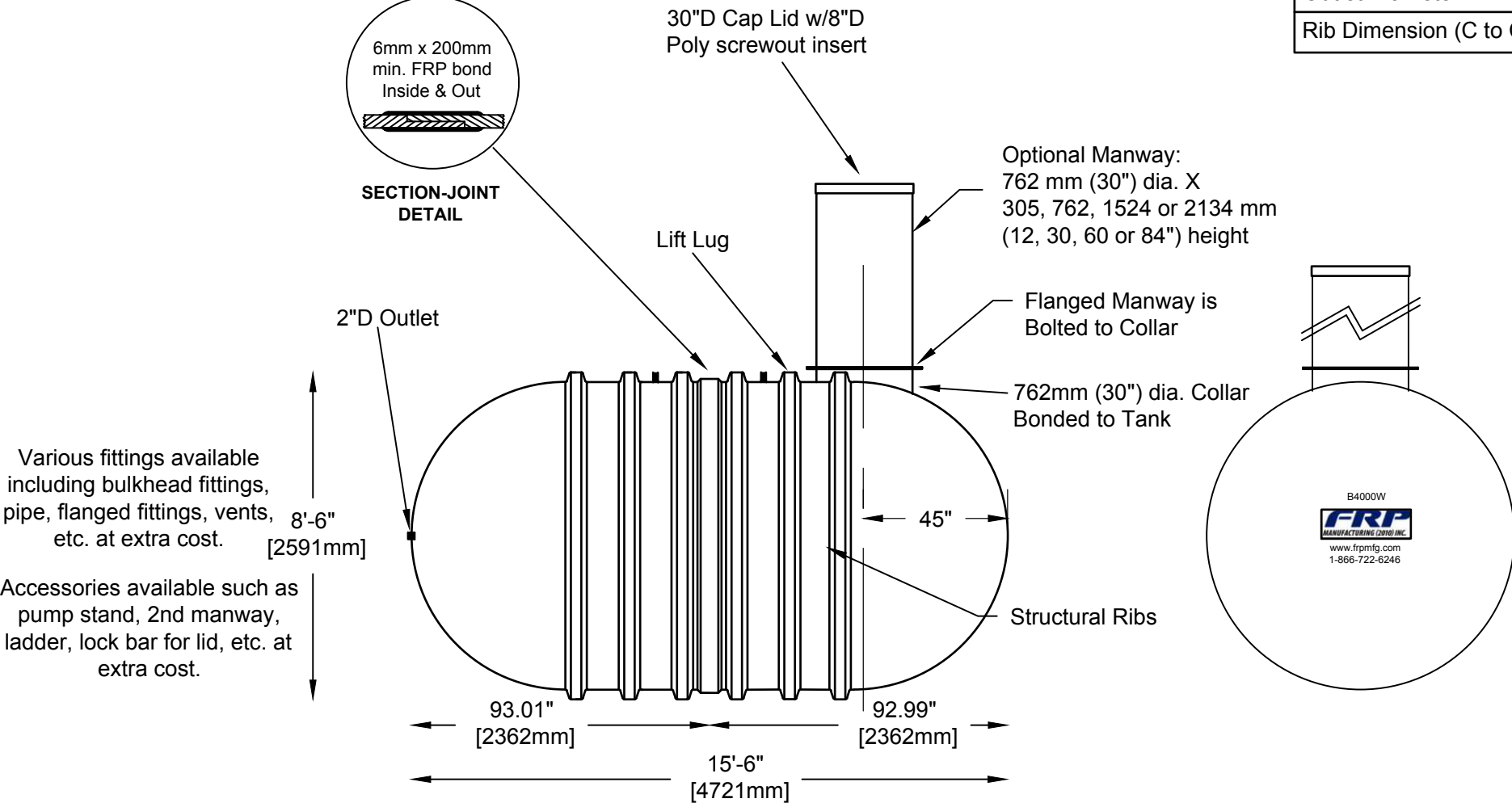

Various fittings available including bulkhead fittings, pipe, flanged fittings, vents, etc. at extra cost.

Accessories available such as pump stand, 2nd manway, ladder, lock bar for lid, etc. at extra cost.



Website: [www.frpmfg.com](http://www.frpmfg.com)  
Toll Free: 1-866-722-6246

B4000W FIBREGLASS WATER CISTERN		DATE: 04-12-2018	DWG SCALE:
Overall Length:	Approx. 4,724mm (15'6" )	BY: MPS	REV: 2
Overall Weight:	Approx. 816 kg (1,800 lbs)	DATE:	
Overall Capacity:	Approx. 18,262L (4,016 Imp Gal, 4,819 US Gal)	APPROVAL:	



Drinking Water  
NSF/ANSI 61