

FLANGE CONNECTION DETAIL

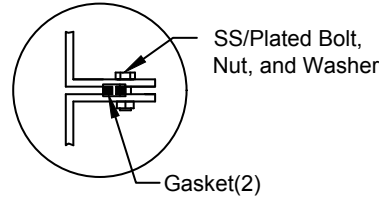

SECTION-JOINT DETAIL

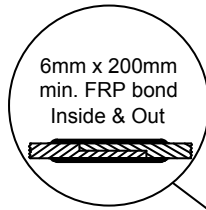

2"D Outlet

8'-6"
[2578mm]

Various fittings available including bulkhead fittings, pipe, flanged fittings, vents, etc. at extra cost.

Accessories available such as pump stand, divider wall(s), 2nd manway, lock bar for lid, etc. at extra cost.

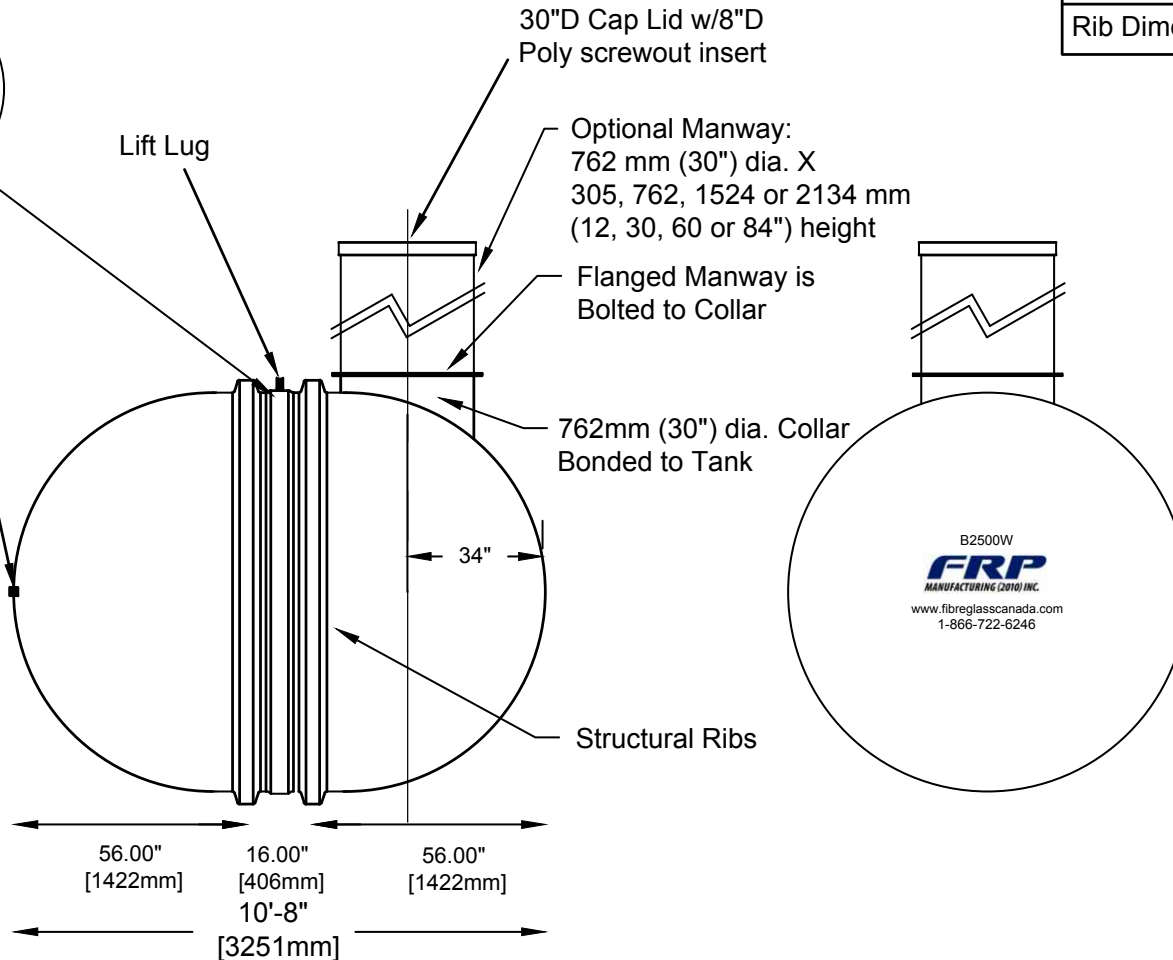

Specifications	
Cylinder Thickness	0.375"
End Cap Thickness	0.475"
Inlet Height (C.L.)	N/A
Outlet Height (C.L.)	48"
Inlet Diameter	N/A
Outlet Diameter	2"
Rib Dimension (C to C)	17.25"

FRP
MANUFACTURING (2010) INC.

B-2500W FIBREGLASS WATER CISTERN

Overall Length:	Approx. 3,251mm (10' 8")
Overall Weight:	Approx. 500 kg (1,100 lbs)
Overall Capacity:	Approx. 11,365L (2,500 Imp Gal, 3,000 US Gal)

DATE: 02-04-2018

DWG SCALE:

BY: MPS

REV: 0

DATE:

APPROVAL:



Drinking Water
NSF/ANSI 61