

FLANGE CONNECTION DETAIL

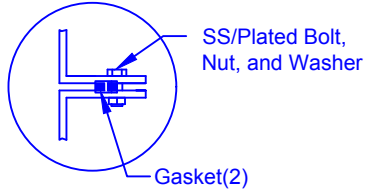

SECTION-JOINT DETAIL

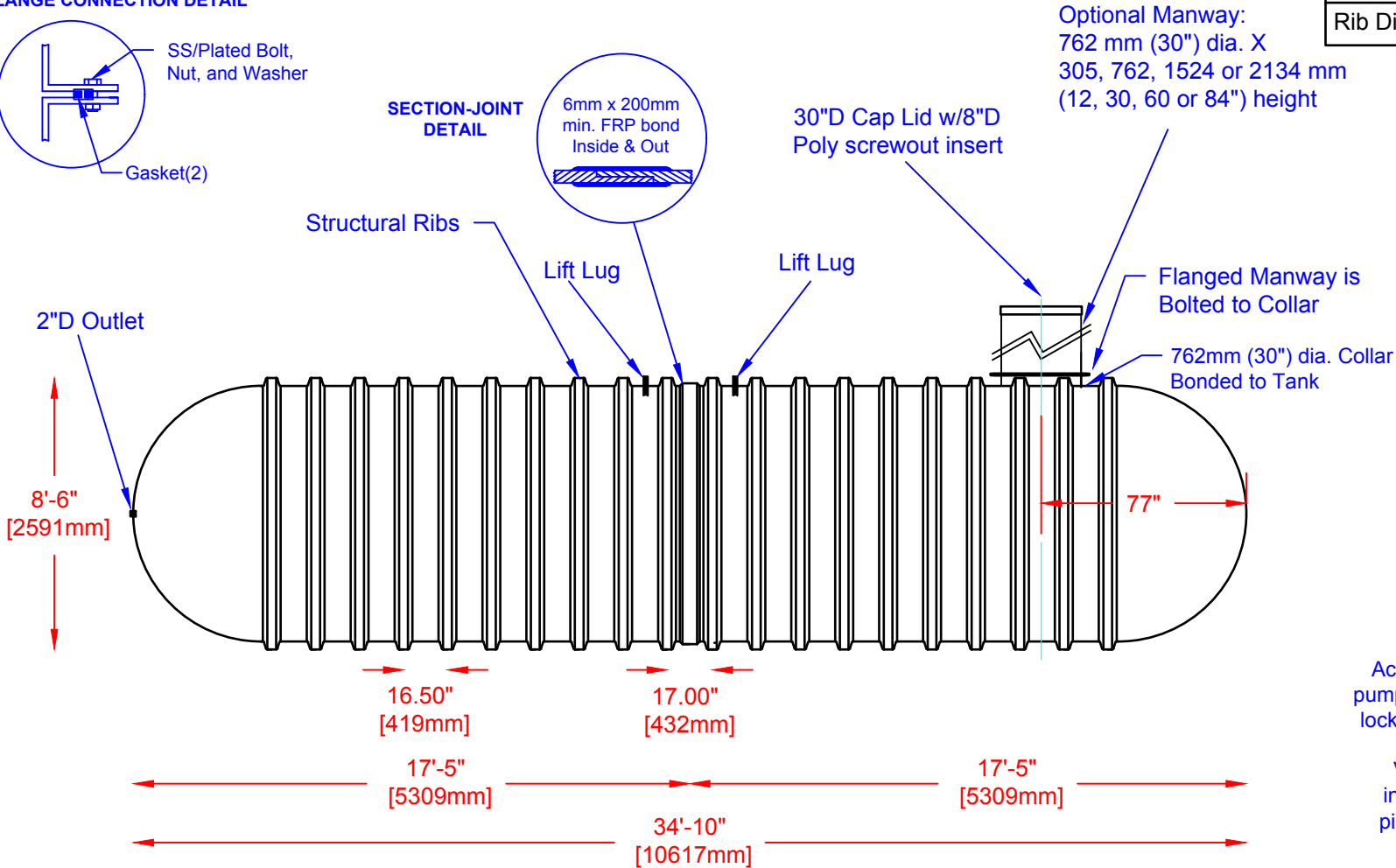

Optional Manway:
762 mm (30") dia. X
305, 762, 1524 or 2134 mm
(12, 30, 60 or 84") height

Flanged Manway is Bolted to Collar

762mm (30") dia. Collar Bonded to Tank

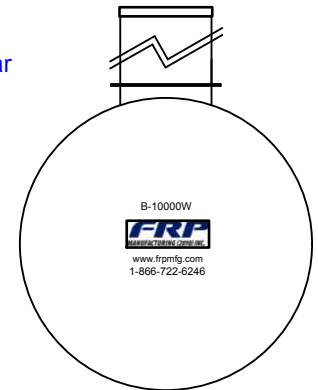

Accessories available such as pump stand, 2nd manway, ladder, lock bar for lid, etc. at extra cost.

Various fittings available including bulkhead fittings, pipe, flanged fittings, vents, etc. at extra cost.

Specifications	
Cylinder Thickness	0.375"
End Cap Thickness	0.475"
Inlet Height (C.L.)	N/A
Outlet Height (C.L.)	48"
Inlet Diameter	N/A
Outlet Diameter	2"
Rib Dimension (C to C)	17.25"



Website: www.frpmlg.com
Toll Free: 1-866-722-6246

B10000W FIBREGLASS WATER CISTERN		DATE: 04-12-2018	DWG SCALE:
Overall Length:	Approx. 10,617mm (34'10")	BY: MPS	REV: 2
Overall Weight:	Approx. 1,746 kg (3,850 lbs)	DATE:	
Overall Capacity:	Approx. 45,770L (10,068 Imp Gal, 12,082 US Gal)	APPROVAL:	



Drinking Water
NSF/ANSI 61